

Classic



Mini Classic

5' 8" Door Height
6' 8" Ext. Low Wall
6' 1" Int. Wall



Traditional Classic

6' 4" Door Height
7' 9" Ext. Low Wall
6' 9" Int. Wall



Tall Classic

6' 10" Door Height
8' 3" Ext. Low Wall
7' 3" Int. Wall



Size	Price
4x8	\$2,966
4x10	3,272
4x12	3,557
4x14	3,887
4x16	4,149

Size	Price
6x8	\$3,421
6x10	3,560
6x12	3,924
6x14	4,262
6x16	4,802
6x18	5,155
6x20	5,346

Size	Price
8x8	\$3,547
8x10	3,919
8x12	4,287
8x14	4,783
8x15	4,970

Size	Price
10x10	\$4,560
10x12	4,970

Size	Price
6x8	\$3,597
6x10	3,734
6x12	4,106
6x14	4,439
6x16	4,969
6x18	5,336
6x20	5,519

Size	Price
8x8	\$3,668
8x10	4,050
8x12	4,534
8x14	4,956
8x15	5,127

Size	Price
10x10	\$4,744
10x12	5,127

Size	Price
6x8	\$3,763
6x10	3,904
6x12	4,284
6x14	4,621
6x16	5,148
6x18	5,537
6x20	5,717

Size	Price
8x8	\$3,891
8x10	4,273
8x12	4,866
8x14	5,178
8x15	5,353

Size	Price
10x10	\$4,966
10x12	5,353

Many features & options available...
See inside panel.



Key Benefits

- Our Classic models are pre-packaged with dozens of features everyone wants in a backyard shed (see "Classic Features" on inside panel).
- Because each shed is built-to-order, you can choose from long list of options to create a unique shed to meet your needs.
- Prices include local delivery and complete set-up on site (delivery fee applies to extended service areas)
- 5-Year materials and workmanship warranty.
- Lifetime floor warranty.

Payment Options

Cash or Check



the shedshop
The Bay Area Shed Leader

3201 Diablo Ave.,
Hayward, CA 94545
(510) 791-7433
M-F 9-5 Sat 10-4

www.shedshop.com
Lic. No. 1062810

Shed Price Notes—Effective 10/2020

- Prices do not include sales tax, paint, or site preparation (if required)
- Delivery fee applies to extended service areas
- Width & length are approximate; please ask about exact dimensions
- Prices subject to change without notice

Sheds over 120 Square Feet...

...typically require a foundation and building permit. Please see our "Titan" brochure for information about buildings in this size range.

**Buildings with "House" Doors

The Shed Shop strongly recommends all sheds with "house" doors be installed over a slab, foundation, or other firm footing.

Classic Features

...included in every Classic building

1. Four-component elevated floor system... guaranteed for the life of the shed

- A. **Cement leveling blocks**
(blocks stacked up to 4 high for severe slopes; redwood & shingle shims added as needed)
- B. **Treated skids/runners**
- C. **Floor joists 16" o.c.**
- D. **3/4 ACX "exterior grade" plywood floor**

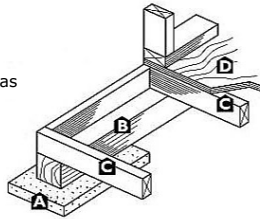

2. Industry standard wall-framing

- wall framing; 2x4 16" o.c.
- Double top plates (except 4&6 ft. "Mini-Classic")
- Double corner studs

3. Vertical Siding



Vertical "SmartSide"

- Pre-primed cedar grain deep embossed surface
- Jungle-tested to resist fungal decay and termites
- Advanced resin adds durability and weather resistance
- Backed by SmartSide 5/50 limited warranty

4. Double-Pane Vinyl Sliding Window

- "Low-E" glass keeps shed cooler
- Includes insect screen
- Mini Classic:
Includes one 3x2
- Traditional & Tall:
Includes one 3x3



5. Extra-Wide Shed Door

- 44.5 inches wide for easy access into shed
- Hung with heavy duty T-hinges
- Locking handle & key
- 2x4 bracing around perimeter and center prevents warping

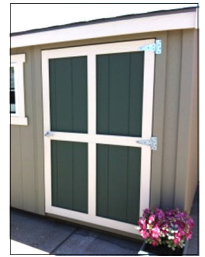

6. Soffit & Fascia Roof Profile

- Rafters overhang the side wall and are boxed in with soffit & fascia
- Shed appearance is dramatically enhanced compared to an ordinary shed



7. Six-Component Roof System

- A. 2x6 dual ridge beams
- B. 2x4 rafters power nailed, not stapled
- C. 1/2" OSB radiant-barrier roof sheathing keeps shed 30% cooler.
- D. "Synfelt" underlay-

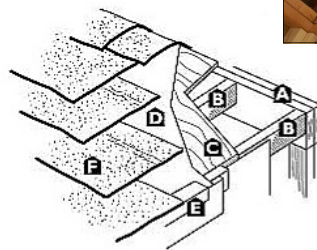
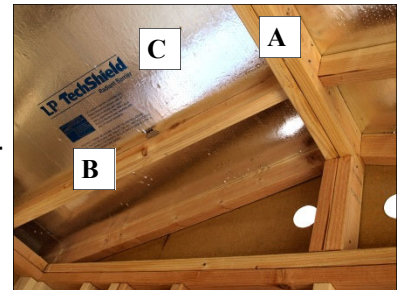

ment

- E. Drip edge protects roof edge from moisture
- F. 30 yr. dimensional shingles; self-sealing; class A fire rated.

8. Shed Protection Package

- 35 yr. silicone-based caulk around corners, door, and window trim protects from moisture
- Circular under-eave vents—4 ea.
- Metal threshold guard protects floor opening from rodents & heavy foot traffic
- Galvanized nails used on all exterior surfaces

"Classic" Options & Upgrades

Customize your shed to meet your needs & expectations

Door Options



- Extra 44" single door **\$150**
- Extra double door
44" wide **\$250**
60" wide **\$300**
- Upgrade single to double
44" wide **\$125**
60" wide **\$175**

Extra Windows



Jeld-Wen Vinyl Double Pane Slider with Grids
3x2, 2x3, or 2x2 **\$280**
3x3 **\$330**
4x3 **\$380**
5x3 **\$420**

Horizontal "SmartSide"



- Add 15% of base price
- Traditional shiplap design
- Jungle-tested to resist fungal decay and termites
- Advanced resin adds durability and weather resistance
- Backed by SmartSide 5/50 limited warranty

Site Consultation



On-Site Consultation **\$100**

- Helps determine the best shed to fit your spot and meet your needs
- Fee is waived if you first visit our showroom
- Available in our local service area after your site has been pre-qualified

"House" Doors



9-Light Door \$505
6-Panel Door \$405

Fixed Windows

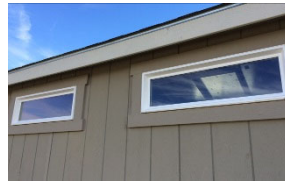

Jeld-Wen Double Pane Mounted High on Wall
3x1 **\$230**
4x1 **\$250**

Roof Options



50 Yr. Presidential Shingles
Add \$2/sq. ft.

- Choice of colors
- Recommended for high-wind areas

Step or Landing



Step \$65
• 48" wide; 18" deep; 7" tall

Landing
• 3'x3' **\$150**
• 4'x3' **\$200**
additional sizes available



9-Light Custom \$555

House Door Features

- Fiberglass skin resists dings
- Includes dual lockset and stainless steel hinges
- We recommend a slab base for all sheds with "house" type doors

Adjustable Shelving



- Maximizes your storage capacity - 300 lb. capacity brackets & standards
- 12" deep; up to 4' long **\$25**
- 16" deep; up to 4' long **\$30**
- 24" deep; up to 4' long **\$40**
(2 shelf minimum per wall)
- 12" deep; 4' to 8' long **\$35**
- 16" deep; 4' to 8' long **\$40**
- 24" deep; 4' to 8' long **\$50**
(2 shelf minimum per wall)

Translucent Roof Vent

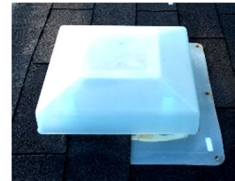

- 12" x 12" **\$95**
Lets in light and ventilation

Dual-Dome Skylight



- 24" x 24" **\$290**

Exterior Paint

- One-Tone Paint** Add **10%**
(\$200 minimum)
- Two-Tone Paint** Add **13%**
(\$300 minimum)
(Extra costs apply to Red or Yellow color choices)

Building Wrap

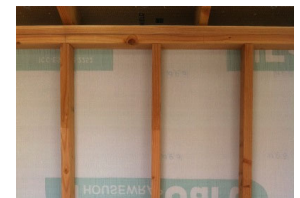

Building Wrap Add 7%

- Brightens interior and gives extra moisture protection
- \$150 Minimum

Workbench

8 ft. Workbench \$175

- 24 in. deep by 8 ft. wide; includes 18 in. under-shelf



Choosing Green?

Choose *The Shed Shop*...
...the "Greenest" sheds in the Bay Area.

"Radiata Pine" 3/4 inch Plywood Floor

Our plywood flooring is produced using wood supplied by ISO 14001 certified plantations. This certification guarantees that all forestry operations are carried out in an environmentally responsible manner and are certified under the PEFC endorsed CERTFOR standard.



Louisiana Pacific "SmartSide" Vertical & Louisiana Pacific "SmartSide" Horizontal Shiplap Siding

LP SmartSide products start with sustainably harvested premium hardwoods, which are then engineered with the non-toxic SmartGuard process. LP SmartSide factories are driven by energy provided by waste wood unfit for use in its products.



Radiant Barrier Roof Sheathing

All Shed Shop sheds feature LP Techshield roof decking, which blocks up to 97% of the radiant heat in the panel from entering your attic area, which keeps your shed cooler.



Wood waste is recycled

At the end of our manufacturing process, all wood waste is sent for recycling.



Low-E Glass Double-Pane Windows

As of Oct. 1, 2009, all windows will have high-performance Low-E insulating glass which helps sheds stay cooler in the summer and warmer in the winter, prevents fading of interior furnishings, and reduces condensation. It also delivers greater light transmittance than tinted glass.

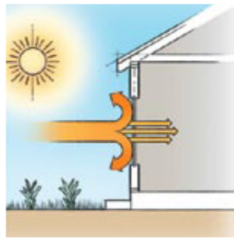

In warm weather, Low-E glass reflects the sun's energy and prevents it from entering the building; reduces amount of heat loss in winter.

"Green" Features of our Studio Sheds

Title 24 Low-Energy Requirements

Our Studio model typically meets California's stringent Title 24 efficiency standards for residential buildings.

Low VOC Interior Paint

Studio interiors are painted with Behr "Premium Plus Ultra" Low VOC paint.



Studio Sheds Built Green



3201 Diablo Ave.
Hayward, CA 94545
(510) 791-7433
M-F 9-5 Sat. 10-4

Since 1989, over 17,000
sheds built in the
San Francisco Bay Area