

Classic

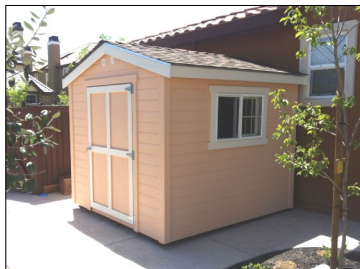

Mini Classic

5' 8" Door Height
6' 8" Ext. Low Wall
6' 1" Int. Wall



Traditional Classic

6' 4" Door Height
7' 9" Ext. Low Wall
6' 9" Int. Wall



Tall Classic

6' 10" Door Height
8' 3" Ext. Low Wall
7' 3" Int. Wall



Peak Height 7' 8"	4x8	\$3,884
	4x10	4,279
	4x12	4,648
	4x14	5,070
	4x16	5,413

Peak Height 7' 8"	6x8	\$4,472
	6x10	4,651
	6x12	5,121
	6x14	5,558
	6x16	6,256
	6x18	6,709
	6x20	6,960

Peak 8' 3"	8x8	\$4,635
	8x10	5,115
	8x12	5,591
	8x14	6,232
	8x15	6,474

Peak 8' 8"	10x10	\$5,944
	10x12	6,474

Peak Height 8' 9"	6x8	\$4,699
	6x10	4,876
	6x12	5,357
	6x14	5,788
	6x16	6,473
	6x18	6,947
	6x20	7,183

Peak 9' 1"	8x8	\$4,792
	8x10	5,285
	8x12	5,910
	8x14	6,456
	8x15	6,677

Peak 9' 6"	10x10	\$6,181
	10x12	6,677

Peak Height 9' 3"	6x8	\$4,913
	6x10	5,095
	6x12	5,587
	6x14	6,023
	6x16	6,704
	6x18	7,206
	6x20	7,440

Peak 9' 7"	8x8	\$5,079
	8x10	5,573
	8x12	6,340
	8x14	6,743
	8x15	6,968

Peak 10'	10x10	\$6,469
	10x12	6,968

Many features & options available...

See inside panel.



Key Benefits

- Our Classic models are pre-packaged with dozens of features everyone wants in a backyard shed (see "Classic Features" on inside panel).
- Because each shed is built-to-order, you can choose from long list of options to create a unique shed to meet your needs.
- Prices include local delivery and complete set-up on site (delivery fee applies to extended service areas)
- 5-Year materials and workmanship warranty.
- Lifetime floor warranty.

Payment Options

Cash or Check



the shedshop
The Bay Area Shed Leader

3201 Diablo Ave.,
Hayward, CA 94545
(510) 791-7433

M-F 9-5 Sat 10-4

www.shedshop.com

Lic. No. 1062810

Shed Price Notes—Effective 11/2022

- Prices do not include sales tax, paint, or site preparation (if required)
- Delivery fee applies to extended service areas
- Width & length are approximate; please ask about exact dimensions
- Prices subject to change without notice

Sheds over 120 Square Feet...

...typically require a foundation and building permit. Please see our "Titan" brochure for information about buildings in this size range.

**Buildings with "House" Doors

The Shed Shop strongly recommends all sheds with "house" doors be installed over a slab, foundation, or other firm footing.

Classic Features

...included in every Classic building

1. Four-component elevated floor system... guaranteed for the life of the shed

- A. **Cement leveling blocks**
(blocks stacked up to 4 high for severe slopes; redwood & shingle shims added as needed)
- B. **Treated skids/runners**
- C. **Floor joists 16" o.c.**
- D. **3/4 ACX "exterior grade" plywood floor**

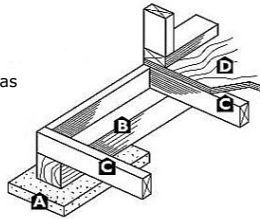

2. Industry standard wall-framing

- wall framing; 2x4 16" o.c.
- Double top plates (except 4&6 ft. "Mini-Classic")
- Double corner studs

3. Vertical Siding



Vertical "SmartSide"

- Pre-primed cedar grain deep embossed surface
- Jungle-tested to resist fungal decay and termites
- Advanced resin adds durability and weather resistance
- Backed by SmartSide 5/50 limited warranty

4. Double-Pane Vinyl Sliding Window

- "Low-E" glass keeps shed cooler
- Includes insect screen
- Mini Classic:
Includes one 3x2
- Traditional & Tall:
Includes one 3x3



5. Extra-Wide Shed Door

- 44.5 inches wide for easy access into shed
- Hung with heavy duty T-hinges
- Locking handle & key
- 2x4 bracing around perimeter and center prevents warping

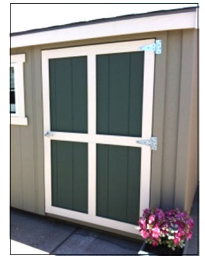

6. Soffit & Fascia Roof Profile

- Rafters overhang the side wall and are boxed in with soffit & fascia
- Shed appearance is dramatically enhanced compared to an ordinary shed



7. Six-Component Roof System

- A. 2x6 dual ridge beams
- B. 2x4 rafters power nailed, not stapled
- C. 1/2" OSB radiant-barrier roof sheathing keeps shed 30% cooler.
- D. "Synfelt" underlay-

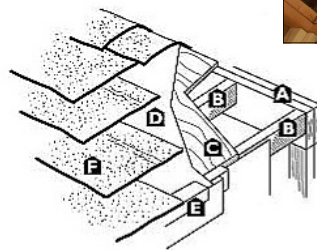
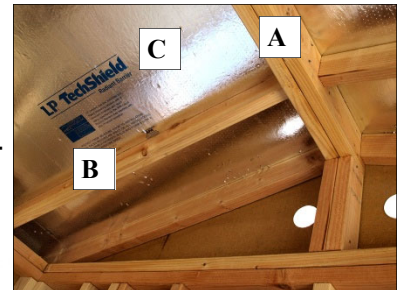

ment

- E. Drip edge protects roof edge from moisture
- F. 30 yr. dimensional shingles; self-sealing; class A fire rated.

8. Shed Protection Package

- 35 yr. silicone-based caulk around corners, door, and window trim protects from moisture
- Circular under-eave vents—4 ea.
- Metal threshold guard protects floor opening from rodents & heavy foot traffic
- Galvanized nails used on all exterior surfaces

"Classic" Options & Upgrades

Customize your shed to meet your needs & expectations

Door Options



- Extra 44" single door **\$175**
- Extra double door
 - 44" wide **\$300**
 - 60" wide **\$325**
- Upgrade single to double
 - 44" wide **\$150**
 - 60" wide **\$200**

Extra Windows



Jeld-Wen Vinyl Double Pane Slider with Grids
3x2, 2x3, or 2x2 **\$330**
3x3 **\$380**
4x3 **\$430**
5x3 **\$470**

Horizontal "SmartSide"



- Add 15% of base price
- Traditional shiplap design
- Jungle-tested to resist fungal decay and termites
- Advanced resin adds durability and weather resistance
- Backed by SmartSide 5/50 limited warranty

Site Consultation



On-Site Consultation **\$100**

- Helps determine the best shed to fit your spot and meet your needs
- Fee is waived if you first visit our showroom
- Available in our local service area after your site has been pre-qualified

"House" Doors



9-Light Door \$605

6-Panel Door \$505



9-Light Custom \$655

House Door Features

- Fiberglass skin resists dings
- Includes dual lockset and stainless steel hinges
- We recommend a slab base for all sheds with "house" type doors

Fixed Windows



Jeld-Wen Double Pane Mounted High on Wall
3x1 **\$230**
4x1 **\$250**

Adjustable Shelving



- Maximizes your storage capacity - 300 lb. capacity brackets & standards
- 12" deep; up to 4' long **\$60**
- 16" deep; up to 4' long **\$65**
- 24" deep; up to 4' long **\$70**
(2 shelf minimum per wall)
- 12" deep; 4' to 8' long **\$80**
- 16" deep; 4' to 8' long **\$85**
- 24" deep; 4' to 8' long **\$90**
(2 shelf minimum per wall)

Roof Options



50 Yr. Presidential Shingles
Add **\$2/sq. ft.**

- Choice of colors
- Recommended for high-wind areas

Translucent Roof Vent

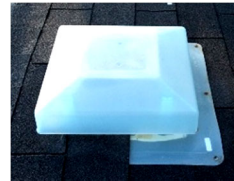

- 12" x 12" **\$120**
Lets in light and ventilation

Dual-Dome Skylight



- 24" x 24" **\$290**

Exterior Paint

- One-Tone Paint** Add **10%**
(\$200 minimum)
- Two-Tone Paint** Add **13%**
(\$300 minimum)
(Extra costs apply to Red or Yellow color choices)

Step or Landing



Step \$90

- 48" wide; 18" deep; 7" tall

Landing

- 3'x3' **\$175**
- 4'x3' **\$225**

additional sizes available

Building Wrap

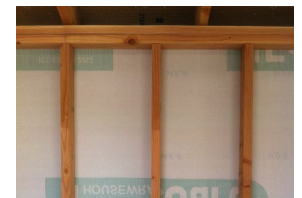

Building Wrap Add 7%

- Brightens interior and gives extra moisture protection
- \$150 Minimum

Concrete

A concrete slab is not always required, but your new shed will look better and be more stable over its lifespan when resting on concrete. You can arrange for concrete yourself; or our minimum cost for a 4" reinforced concrete slab up to 120 sq. ft. is \$3,850 plus site preparation (if required).

Workbench

8 ft. Workbench \$175

- 24 in. deep by 8 ft. wide; includes 18 in. under-shelf



Choosing Green?

Choose *The Shed Shop*...
...the "Greenest" sheds in the Bay Area.

"Radiata Pine" 3/4 inch Plywood Floor

Our plywood flooring is produced using wood supplied by ISO 14001 certified plantations. This certification guarantees that all forestry operations are carried out in an environmentally responsible manner and are certified under the PEFC endorsed CERTFOR standard.



Louisiana Pacific "SmartSide" Vertical & Louisiana Pacific "SmartSide" Horizontal Shiplap Siding

LP SmartSide products start with sustainably harvested premium hardwoods, which are then engineered with the non-toxic SmartGuard process. LP SmartSide factories are driven by energy provided by waste wood unfit for use in its products.



Radiant Barrier Roof Sheathing

All Shed Shop sheds feature LP Techshield roof decking, which blocks up to 97% of the radiant heat in the panel from entering your attic area, which keeps your shed cooler.



Wood waste is recycled

At the end of our manufacturing process, all wood waste is sent for recycling.



Low-E Glass Double-Pane Windows

As of Oct. 1, 2009, all windows will have high-performance Low-E insulating glass which helps sheds stay cooler in the summer and warmer in the winter, prevents fading of interior furnishings, and reduces condensation. It also delivers greater light transmittance than tinted glass.

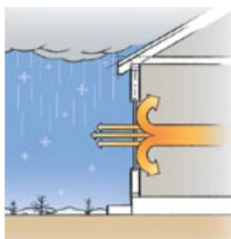

In warm weather, Low-E glass reflects the sun's energy and prevents it from entering the building; reduces amount of heat loss in winter.

"Green" Features of our Studio Sheds

Title 24 Low-Energy Requirements

Our Studio model typically meets California's stringent Title 24 efficiency standards for residential buildings.

Low VOC Interior Paint

Studio interiors are painted with Behr "Premium Plus Ultra" Low VOC paint.

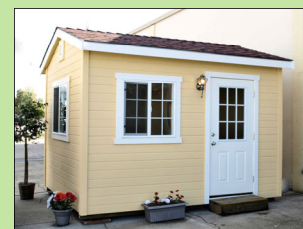

Studio Sheds Built Green



3201 Diablo Ave.
Hayward, CA 94545
(510) 791-7433
M-F 9-5 Sat. 10-4

Since 1989, over 17,000
sheds built in the
San Francisco Bay Area